

vtech®

User's Manual

**Go!Go!
Smart Friends®**
Playtime where friendship leads to learning!™

Secret Blossom Cottage™



© 2016 VTech
Printed in China
91-003217-000 (US)

Dear Parent,

Welcome to the world of **Go! Go! Smart Friends**®! We're excited you've decided to go on an adventure with us and explore all that **Go! Go! Smart Friends**® has to offer. These toys have been designed to give your child a thrilling learning experience with hours of fun.

Go! Go! Smart Friends® features a collection of characters and playsets (each sold separately) that interact with your child by lighting up and playing fun responses. They introduce themselves, talk about their favorite things and more while encouraging first words and early vocabulary. But that's only the beginning of the learning excitement!

When your child interacts with our innovative **MagicPoint**™ technology, they will love watching the characters and playsets come to life with motion, lights, music, and sounds as they play!

Additionally, our **Go! Go! Smart Friends**® playsets feature buttons, gears and other manipulative elements to encourage the development of your child's fine motor skills. Some playsets also have walkway track pieces that can be connected to other **Go! Go! Smart Friends**® playsets with walkway track pieces as well as **Go! Go! Smart Wheels**® and **Go! Go! Smart Animals**® playsets (each sold separately) to encourage creativity.

With **Go! Go! Smart Friends**®, it's playtime where friendship leads to learning™!

Sincerely,

Your friends at **VTech**®

To learn more about **VTech**® toys, visit vtechkids.com

INTRODUCTION

Thank you for purchasing the **VTech® Go! Go! Smart Friends® Secret Blossom Cottage™!** Watch the **Secret Blossom Cottage™** come to life when you place the included character on the **MagicPoint™** locations! Turn the fountain to make it spin, rock the hammock or turn the gears for more fun play.

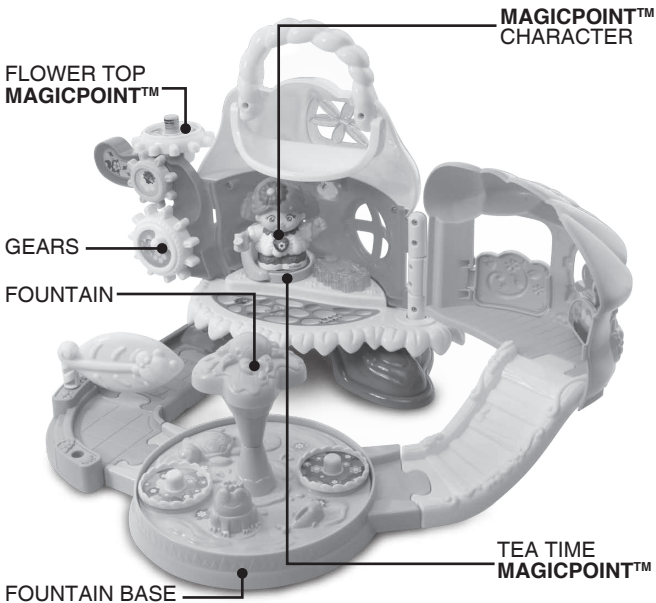

INCLUDED IN THIS PACKAGE

NOTE: This toy is not intended for teething.



- One Go! Go! Smart Friends® MagicPoint™ character - Fairy Sunny



- Tea time MagicPoint™ location



- One base

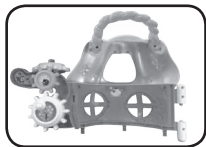

- One roof with handle



- One hammock



- One window



- One wall with moving bird



- One door



- One leaf gate

INCLUDED IN THIS PACKAGE



- One fountain base



- One fountain top

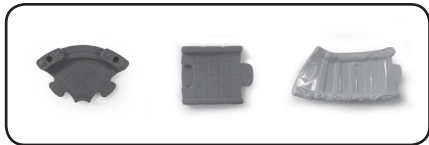

- One 90-degree curved track
- One 1/2 track
- One stair track

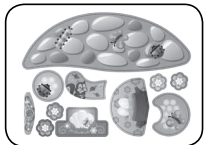

- One label sheet
- User's manual

Unlock the packaging locks:

There is one packaging lock located on the character.

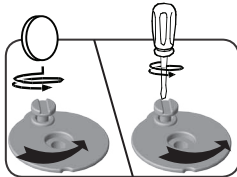

- ① Use a coin or a screwdriver to loosen the screw.
- ② Pull out the screw with the packaging lock.

WARNING: All packing materials such as; tape, plastic sheets, packaging locks and tags are not part of this toy, and should be discarded for your child's safety.

ATTENTION: Pour la sécurité de votre enfant, débarrassez-vous de tous les produits d'emballage tels que rubans adhésifs, feuilles de plastique, attaches et étiquettes. Ils ne font pas partie du jouet.

NOTE: Please keep this user's manual as it contains important information.

GETTING STARTED

BATTERY INSTALLATION - CHARACTER

1. Make sure the unit is **OFF**.
2. Locate the battery cover on the bottom of the unit.
Use a screwdriver to loosen the screws.
3. Install 2 new "AAA" size (LR03/AM-4) batteries following the diagram inside the battery box. (The use of new alkaline batteries is recommended for maximum performance.)
4. Replace the battery cover and tighten the screws to secure.

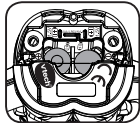
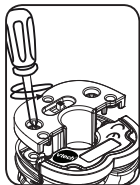

BATTERY NOTICE

- Use new alkaline batteries or fully charged NI-MH (Nickel Metal-hydride) rechargeable batteries for best performance.
- Use only batteries of the same or equivalent type as recommended.
- Do not mix different types of batteries: alkaline, standard (carbon-zinc) or rechargeable (Ni-Cd, Ni-MH), or new and used batteries.
- Do not use damaged batteries.
- Insert batteries with the correct polarity.
- Do not short-circuit the battery terminals.
- Remove exhausted batteries from the toy.
- Remove batteries during long periods of non-use.

- Do not dispose of batteries in fire.
- Do not charge non-rechargeable batteries.
- Remove rechargeable batteries from the toy before charging (if removable).
- Rechargeable batteries are only to be charged under adult supervision.

CAUTION:

Adult assembly required. For your child's safety, do not let your child play with the toy until it is fully assembled.

ASSEMBLY INSTRUCTIONS

With the VTech® Go! Go! Smart Friends® Secret Blossom Cottage™, safety comes first. To ensure your child's safety, adult assembly is required.

1. Locate the fountain base, then insert the fountain top into the base as shown.

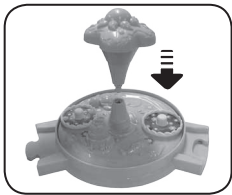

2. Attach the tea time area to the base.



3. Attach the window to the roof.

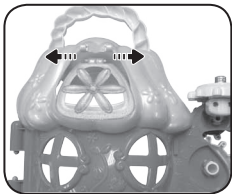

4. Attach the hammock to the roof.

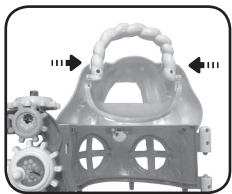

5. Attach the door to the wall.

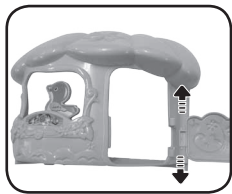

6. Attach the wall to the roof.

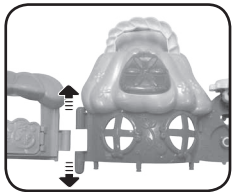

7. Attach the assembled cottage to the tea time area on the base.



8. Attach the leaf gate to the 90-degree curved track.

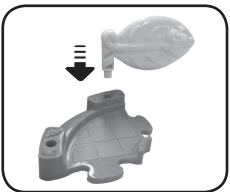

9. After the above steps, connect the cottage and fountain to the three included walkway track pieces. Explore the **Secret Blossom Cottage™** on both sides and configure the playset in different ways.



10. Close the cottage and carry it by the handle for on-the-go play.



LABEL APPLICATION

Please stick the labels to the playset securely as indicated below:

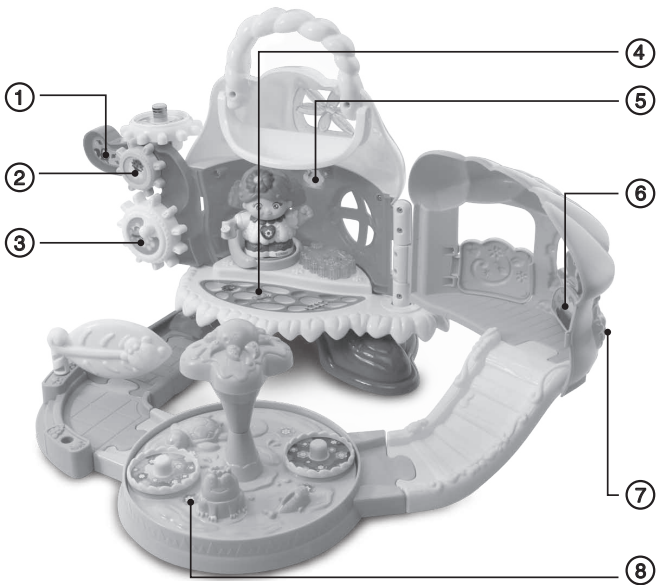

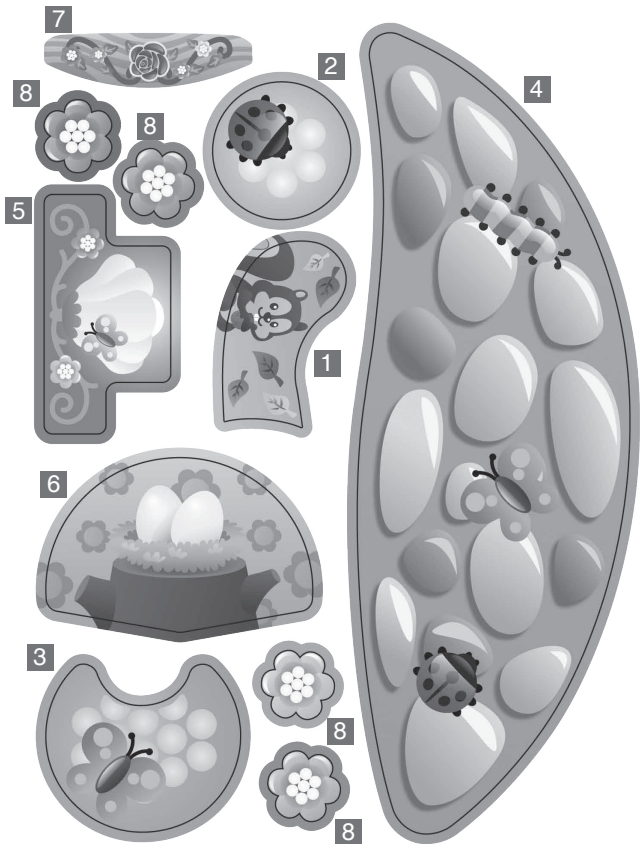

PRODUCT FEATURES

1. ON/OFF SWITCH

The **ON/OFF SWITCH** is located on the bottom of the character.

To turn the unit on, slide the **ON/OFF SWITCH** to the **ON** (⏻) position. To turn the unit off, slide the **ON/OFF SWITCH** to the **OFF** (●) position.

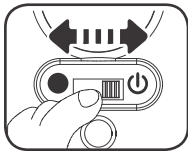

2. AUTOMATIC SHUT-OFF

To preserve battery life, the **VTech® Go! Go! Smart Friends®** character will automatically power down after several minutes of no input. The unit can only be turned on again by pressing the **LIGHT-UP BUTTON** or placing it on a **MagicPoint™** location.

The **LIGHT-UP BUTTON** will flash several times and power down when the unit's battery level is low.

ACTIVITIES – CHARACTER

1. Press the **LIGHT-UP BUTTON** to hear phrases, songs, melodies and fun sounds.

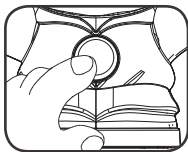

2. Place the character on one of the cottage's two **MagicPoint™** locations to hear phrases, fun sounds and sing-along songs. The character can also interact with other **VTech® Go! Go! Smart Friends®** playsets (each sold separately).

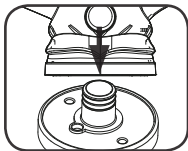

ACTIVITIES – Secret Blossom Cottage™

1. Place the character on the **FLOWER TOP MAGICPOINT™** location to hear fun phrases.



2. The tea time area lights up when you place the character on the **MagicPoint™** location.



MOTOR SKILLS DEVELOPMENT

1. Turn the fountain to spin the **MagicPoint™** character.



2. Turn the gears to watch the flowers spin.



3. Rock the hammock.



4. Move the bird, open the door or flip the window.



CARE & MAINTENANCE

1. Keep the unit and its metal parts clean by wiping them with a slightly damp cloth.
2. Keep the unit out of direct sunlight and away from any direct heat sources.
3. Remove the batteries when the unit is not in use for an extended period of time.
4. Do not drop the unit on a hard surface and do not expose the unit to excess moisture or water.

TROUBLESHOOTING

If for some reason the unit stops working or malfunctions while playing with the **MagicPoint™** accessory, please remove the character from the accessory and place the character back onto the **MagicPoint™** location.

If the unit still does not function, or if for some reason the unit stops

working or malfunctions on its own, please follow these steps:

1. Please turn the unit **OFF**.
2. Interrupt the power supply by removing the batteries.
3. Let the unit stand for a few minutes, then replace the batteries.
4. Turn the unit **ON**. The unit should now be ready to play again.
5. If the product still does not work, replace with a new set of batteries.

If the problem persists, please call our Consumer Services Department at 1-800-521-2010 in the U.S. or 1-877-352-8697 in Canada, or by going to our web site at www.vtechkids.com and filling out our Contact Us form located under the Customer Support link. A service representative will be happy to help you.

IMPORTANT NOTE:

Creating and developing VTech® Toddler Learning products is accompanied by a responsibility that we at VTech® take very seriously. We make every effort to ensure the accuracy of the information which forms the value of our products. However, errors sometimes can occur. It is important for you to know that we stand behind our products and encourage you to call our Consumer Services Department at 1-800-521-2010 in the U.S. or 1-877-352-8697 in Canada, or by going to our web site at www.vtechkids.com and filling out our Contact Us form located under the Customer Support link with any problems and/or suggestions that you might have. A service representative will be happy to help you.

**CLASS 1
LED PRODUCT**



PRODUCT WARRANTY

This Warranty is applicable only to the original purchaser, is non-transferable and applies only to "VTech" products or parts. This product is covered by a 3-month Warranty from the original purchase date, under normal use and service, against defective workmanship and materials. This Warranty does not apply to (a) consumable parts, such as batteries; (b) cosmetic damage, including but not limited to scratches and dents; (c) damage caused by use with non-VTech products; (d) damage caused by accident, misuse, unreasonable use, immersion in water, neglect, abuse, battery leakage, or improper installation, improper service, or other external causes; (e) damage caused by operating the product outside the permitted or intended uses described by VTech in the owner's manual; (f) a product or part that has been modified (g) defects caused by normal wear and tear or otherwise due to the normal aging of the product; or (h) if any VTech serial number has been removed or defaced.

Prior to returning a product for any reason, please notify the VTech Consumer Services Department by going to our web site at www.vtechkids.com, filling out our Contact Us form located under the Customer Support link or calling 1-800-521-2010.

If the service representative is unable to resolve the issue, you will be provided instructions on how to return the product and have it replaced under Warranty. Return of the product under Warranty must adhere to the following rules: If VTech believes that there may be a defect in the materials or workmanship of the product and can confirm the purchase date and location of the product, we will at our discretion replace the product with a new unit or product of comparable value. A replacement product or parts assumes the remaining Warranty of the original product or 30 days from the date of replacement, whichever provides longer coverage.

THIS WARRANTY AND THE REMEDIES SET FORTH ABOVE ARE EXCLUSIVE AND IN LIEU OF ALL OTHER WARRANTIES, REMEDIES AND CONDITIONS, WHETHER ORAL, WRITTEN, STATUTORY, EXPRESS OR IMPLIED. IF VTECH CANNOT LAWFULLY DISCLAIM STATUTORY OR IMPLIED WARRANTIES THEN TO THE EXTENT PERMITTED BY LAW, ALL SUCH WARRANTIES SHALL BE LIMITED TO THE DURATION OF THE EXPRESS WARRANTY AND TO THE REPLACEMENT SERVICE AS DETERMINED BY VTECH IN ITS SOLE DISCRETION.

To the extent permitted by law, VTech will not be responsible for direct, special, incidental or consequential damages resulting from any breach of Warranty.

This Warranty is not intended to persons or entities outside the United States of America. Any disputes resulting from this Warranty shall be subject to the final and conclusive determination of VTech.